

## 陰道栓劑 用藥指導單

1. 雙手洗淨。
  2. 將外包裝拆去。(若自冰箱取出，可以先以溫水濕潤)。
  3. 仰臥曲膝，雙腿分開，以食指將藥儘量送入陰道深部(約一指深處)。
  4. 繼續保持躺姿 15 分鐘。
  5. 投與栓劑後應再洗淨雙手。
- ◆ 栓劑請放冰箱 ( 2-8°C )。

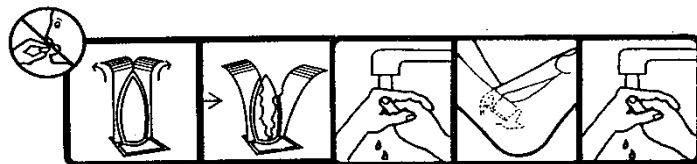

## Instruction of Vaginal Suppositories or Tablets

1. Wash your hands.
  2. Remove the foil wrapper. (You may moisten the suppository with water.)
  3. Lie on your back, with your knees drawn up. Use your finger to insert the suppository into the vagina as far as you can without using force or causing discomfort.
  4. Wait 15 minutes before getting up.
  5. Wash your hands after you have inserted the suppository.
- ◆ Keep the vaginal suppositories in a refrigerator. (2-8°C)

